

ÜBERSICHTSZEICHNUNG

ASSEMBLY DRAWING

GHOST



HYB Teru (MY20)

2019-08-20

V01

ÜBERSICHTSZEICHNUNG ASSEMBLY DRAWING

GHOST

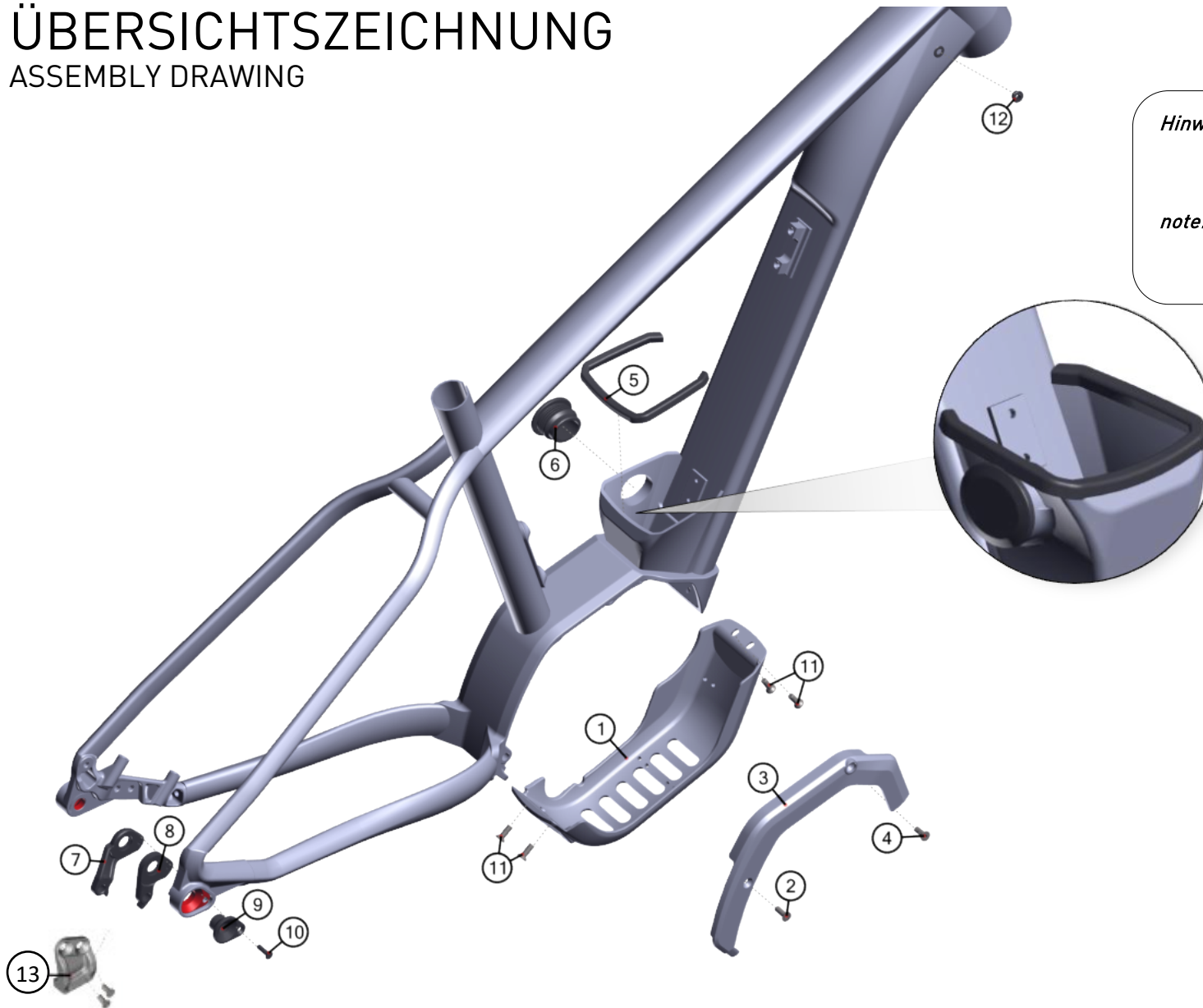

Hinweis:

Bei den Schrauben muss mittelfeste Gewindesicherung verwendet werden.
Rote Flächen müssen gefettet werden.

note:

use medium strength screw lock for screw threads.
red surfaces have to be greased.

FACT SHEET:

SHOCK LENGTH:	----
SHOCK HARDWARE:	
TOP:	----
BOTTOM:	----
HEADSET:	
TOP:	ZS 44
BOTTOM:	ZS 56
SEATPOST DIAMETER:	31.6 MM
CLAMP INNER DIAMETER:	34.9 MM
BOTTOM BRACKET:	----
KICKSTAND:	KSA18 (Adapter)
ISCG STANDARD:	----
CARRIER MOUNT:	YES

ÜBERSICHTSZEICHNUNG

ASSEMBLY DRAWING

GHOST

BOM-ID	Description	Specification	Torque	Item no.	QTY
1	Engine Cover black			FROT0033	1
2	Countersunk screw	HEX3 - M5 x 15mm	5 Nm	FRSC0012	1
3	Engine Side Cover			FROT0028	1
4	Countersunk screw	HEX3 - M5 x 20mm	5 Nm	FRSC0013	1
5	Battery Water-proof pad			FROT0012	1
6	battery rubber plug			FROT0011	1
7	Shimano Hanger (B1)			FRHG0022	1
8	SRAM Hanger (B2)			FRHG0021	1
9	Hanger Mount			FRNT0061	1
10	Flat Head Screw M4	T15 - M4 x 20mm	0,8 Nm	FRSC0061	1
11	Countersunk screw	T25 - M5 x 11mm	5 Nm	SM0920	4
12	Kabelführung Displaykabel			SM1664	1
13	Kickstand Adapter & Screws			GA0128	1
not illustrated	Set with Kickstand, Adapter & Screw			GA0127	1